

To FIND a doctor out of New England: email me your town and state
heather.meninger@sau55.net

For Doctors that participate in Florida CLICK the link below:

https://providersearch.floridablue.com/providersearch/pub/index.htm?_ga=2.29374975.1132830369.1495124978-1318971105.1495124978

Scroll down to "Just Browsing"

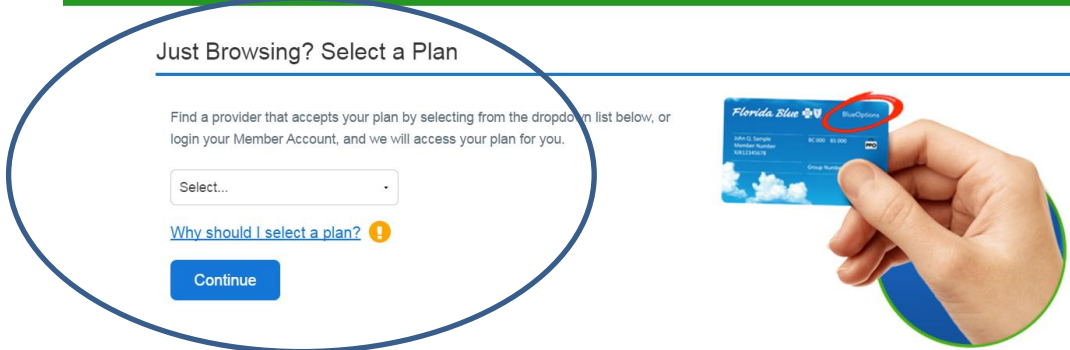
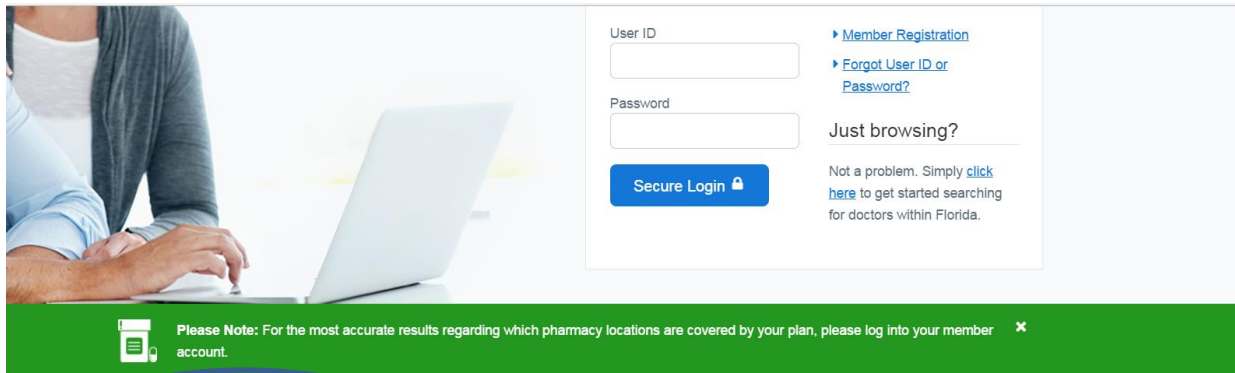

Select BLUECHOICE from the list:

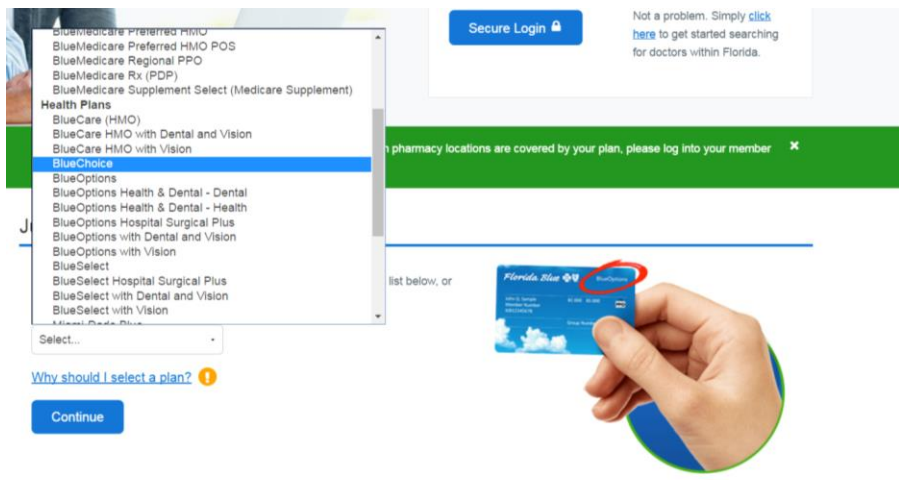

Click Continue:

Please Note: For the most accurate results regarding which pharmacy locations are covered by your plan, please log into your member account.

Just Browsing? Select a Plan

Find a provider that accepts your plan by selecting from the dropdown list below, or login your Member Account, and we will access your plan for you.

BlueChoice

Why should I base my plan?

Continue



Fill in Town and Provider type and click Search Now:

Home Members Employers Agents Providers

Florida Blue Find a Plan Find a Doctor Find a Pharmacy

Find a Doctor & More

Find a doctor by name in your area or search for doctors, dentists, and other specialists that participate in your Florida Blue network. Also find medical facilities such as hospitals, urgent care centers and imaging centers as well as pharmacies and other types of providers.

Provider Last Name or Business Name: Search Within: Enter Location.*

50 miles Orlando

Provider Type: Primary Care

Specialty: All

Doctor's Gender: No Preference

Doctor Speaks: No Preference

Staff Speaks: No Preference

Accepting New Patients: No Preference

Programs: What is this?

Office Hours: No Preference

Search Now

Change your location to your town.

Change to Primary Care