

2 LEVEL 1  
 1/4\"/>

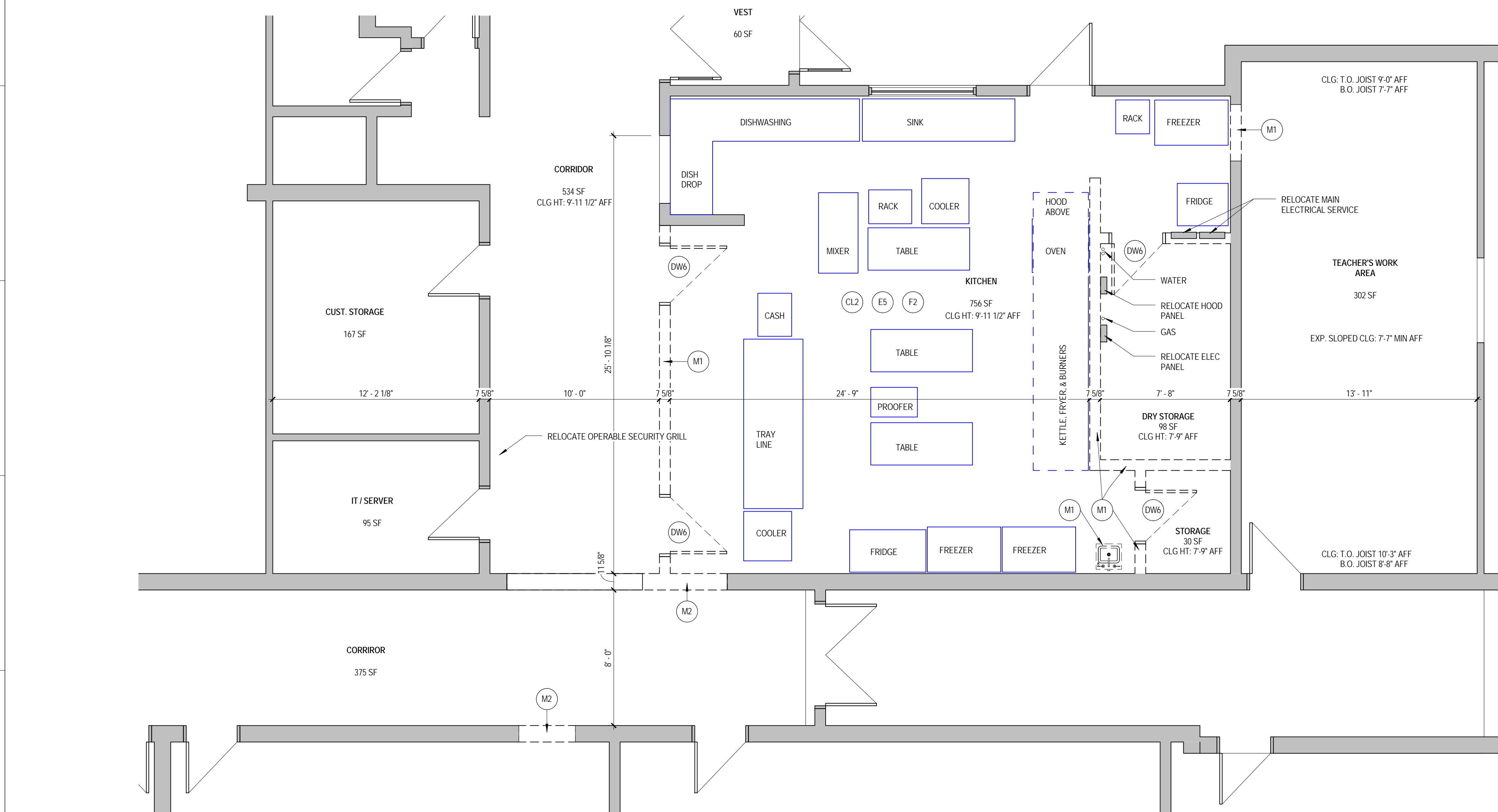

1 LEVEL 1-DEMOLITION  
 1/4\"/>

**DEMOLITION LEGEND:**

- (S1) DEMOLITION NOTE
- EXISTING CONSTRUCTION TO REMAIN
- - - - EXISTING CONSTRUCTION TO BE REMOVED

**DEMOLITION NOTES:**

- GENERAL NOTES:**
- The demolition plans and elevations illustrate the concept of the architectural demolition. They are not intended to be a complete representation of all demolition work required. All Drawings and Specifications are to be considered when determining the scope of demolition for the Project. It is the intent of the Drawings and Specifications to require demolition of all building elements as necessary for the installation of work required by the Scope of this Project.
  - Dashed lines generally represent items to be removed. It is the Contractor's responsibility to field verify exact limits and details of required demolition and coordinate with plans and details.
  - Remove partitions to structure above, unless otherwise indicated by construction details.
  - Remove masonry for new openings as required for the installation of new lintels.
  - Remove doors, frames and hardware including sidelights, transoms and thresholds where doors are shown dashed, unless otherwise indicated.
  - Remove portions of all suspended ceilings for the installation of new work to be done above ceilings, unless otherwise indicated. Save usable components for reinstallation where ceilings are not being replaced.
  - Remove all chalk, marker and tack boards, shelving and other equipment on walls to be removed or furled.
  - Remove concrete slabs and fills as required for installation of new mechanical, electrical and plumbing services. See Mechanical, Electrical and Plumbing Drawings.

**CONCRETE**

- C1 Remove portions of slab and fills for new footings or utilities.

**STRUCTURE**

- S1 Remove ceiling, roof beams, joists, decking, roof insulation, roofing complete.
- S2 Remove concrete plank, roofing complete.
- S3 Remove steel lintel, provide temporary support for new opening

**MASONRY**

- M1 Remove portion of masonry wall.
- M2 Remove portion masonry bearing wall as required for new work. Provide temporary support.

**PARTITIONS**

- P1 Remove stud and gypsum board partition.
- P2 Remove gypsum board soffits complete.
- P3 Remove portion of partition for new opening.

**DOORS AND WINDOWS**

- DW1 Remove existing window(s) complete.
- DW2 Remove door and hardware only (existing frame to remain).
- DW3 Remove existing door and frame for relocation.
- DW4 Remove roll-up door complete.
- DW5 Remove louvers complete.
- DW6 Remove door and frame.

**FLOORING AND FINISH**

- F1 Remove VCT / vinyl sheet flooring.
- F2 Remove ceramic flooring complete.
- F3 Remove base.

**CEILINGS**

- CL1 Remove acoustic ceiling system complete.
- CL2 Remove drywall ceiling system complete.
- CL3 Remove portions of drywall ceiling as required for work above ceiling.

**CASEWORK AND MILLWORK**

- CM1 Remove cabinets, counters and plumbing fixtures. See Mechanical, Electrical and Plumbing Drawings.
- CM2 Remove countertop.

**EQUIPMENT**

- E1 Remove lockers complete.
- E2 Remove display boards, window treatments, miscellaneous equipment complete.
- E3 Remove shelving, racks, hooks complete.
- E4 Remove metal gate and receiver track. Save for reuse.
- E5 Remove food service equipment complete. See Food Service Drawings.
- E6 Remove plumbing fixtures complete. See Plumbing Drawings.
- E7 Remove HVAC equipment. See Mechanical Drawings.

Timberlane Regional School District

295 Main Street, Sandown, NH 03873

| NO. | DESCRIPTION | DATE |
|-----|-------------|------|
|     |             |      |
|     |             |      |
|     |             |      |
|     |             |      |
|     |             |      |
|     |             |      |
|     |             |      |
|     |             |      |
|     |             |      |
|     |             |      |

ARCHITECT TO VERIFY:

- DELETE / EDIT / ADD NOTES PER PROJECT
- RETAIN STANDARD NUMBERING SYSTEM

|  |              |
|--|--------------|
| CONTENT:<br>FIRST FLOOR PLAN   |              |
| DRAWN BY:  | Author       |
| PROJECT NO.:   | 0000         |
| DATE:  | 10/31/2013   |
| REVISED:   |              |
| SCALE:   | As indicated |
| A1.1   |              |
| Project Phase<br><b>PRELIMINARY</b>  |              |
| COPYRIGHT © 2013 BY LAVALLEE BRENSINGER PROFESSIONAL ASSOCIATION. ALL RIGHTS RESERVED. NO REPRODUCTION WITHOUT PERMISSION. |              |

C:\Projects\131047 Sandown School Kitchen-CENTRAL\_bvns.mhahead.rvt 10/31/2013 9:58:45 AM